

4 The Generation



FEATURES

- 2055 sq. ft. Cape Cod, 3 Bedroom, 2 1/2 Baths
- Four season sun room off kitchen
- Energy Star rated home
- Universal open joist floor system
- Huber zip system wall & roof sheathing
- Rinnai dual tankless water heaters
- Rheem 4 zone heating & cooling system
- Insulated garage
- Nutone central vacuum for air quality
- Tiger Wood hardwood flooring throughout home
- Creative tile work design throughout home
- Granite countertops
- Master shower with body jets & rain spout
- Custom mahogany stair case & balcony
- Therma-Tru mahogany stained fiberglass front entrance door
- Heat & Glow glass fireplace designed to install a TV above
- Glass transoms above 1st floor interior doors
- Custom Trex decking & railing
- Owens Corning stone façade
- 2-story foyer & great room ceiling
- Master bedroom tray ceiling with bay window
- Dining area with built-in buffet
- Mira Tec wood composite exterior trim
- Built-in surround sound on 1st floor
- Extensive landscaping
- Cactus Board basement system
- Recess lights throughout home
- Elk 30 yr. Architectural roof
- Custom bath fixtures by Porcelain
- Glass block windows in basement
- Atlas quality workmanship



Atlas Builders



designer
Michael & Randy Spaan

furnishings
Viking International
Furniture
(585) 272-0730

Nan Miller Gallery
(585) 292-1430

Different Point of View
(585) 264-1770

sales
Michael J. Spaan
Atlas Builders
(585) 381-7777

architect
James Fahy Design
(585) 272-1650

landscaping
Design by Pietro Furgivele
Installation by
Atlas Builders

DESIGN

Atlas Builders builds homes for all generations in mind. "The Generation" was designed and constructed for the homeowner that is looking for their dream home combined with advanced technologies and energy efficiencies of the 21st century home. The Generation is a cottage style cape cod with an open floor plan. The exterior of this cape is exquisite in every accent and shape. From its slanted roof line, red rock cultured stone, to the barreled entrance way which leads through to a mahogany stained fiberglass door.

When you walk through The Generation you are welcomed into an open floor plan that includes a two-story foyer, a great room, the kitchen and the dining room. The excitement continues up the custom mahogany stair case with a balcony overlooking the exotic tiger wood cherry floor.

The master suite was designed for comfort and luxury which includes a tray ceiling. You will relax by the bay window sitting area and then enjoy the body spray shower and rainspout. In your master suite spa the custom tile shower

will be illuminated by LED lighting.

The Camelot maple medallion kitchen's location is ideal for entertaining or just everyday living. This area features a breakfast bar with granite countertops and plenty of recess lighting.

The study was designed to be conveniently located between the kitchen and laundry room. Easy access to the computer while doing laundry and preparing a meal.

The dining room includes a built in pecan maple buffet. It also features a bay sliding glass door that leads out to the trex wrap around deck.

Our special feature is the four season sun room that faces south. This sun room has custom tile floor that you won't want to miss. When you walk out onto the trex deck your gas grill is conveniently located.

The Generation is full of special details that work well for both family entertainment and entertaining guests. The Generation was designed and constructed with these key objectives in mind.

THE BUILDER

Michael and Randy Spaan of Atlas Builders are proud to be part of Homearama 2007 in Penfield, the town we reside. Atlas Builders primary goal is to build on the past, concentrate on the present and keep an innovative eye on the future.

With that in mind we made a concerted effort to implement Green Building Products into The Generation. The Generation was constructed with an open floor joist system, zip system wall and roof sheathing, dual tankless water heaters and a four zone heating and cooling system. We took advantage of the southern exposure in order to enjoy the sun and shade in the four season room without using the air conditioning.

Michael and Randy bring nearly 20 years of Award Win-

ning detailed, custom home building experience and decorative planning to The Generation. Our success has been based on having dedicated employees and subcontractors that have been committed to grow with us over the past two decades. Our goal with every project is to create and design a home that truly meets the needs and desires of our customer. We feel our strength is in the ability to accomplish our customer's dreams. The decorative scheme incorporates our personal choices of colors, fabrics, and furnishings that we believe compliment The Generation. Please come to celebrate and enjoy The Generation with us. As with every project we do, we truly enjoyed building and decorating this special home.



first floor

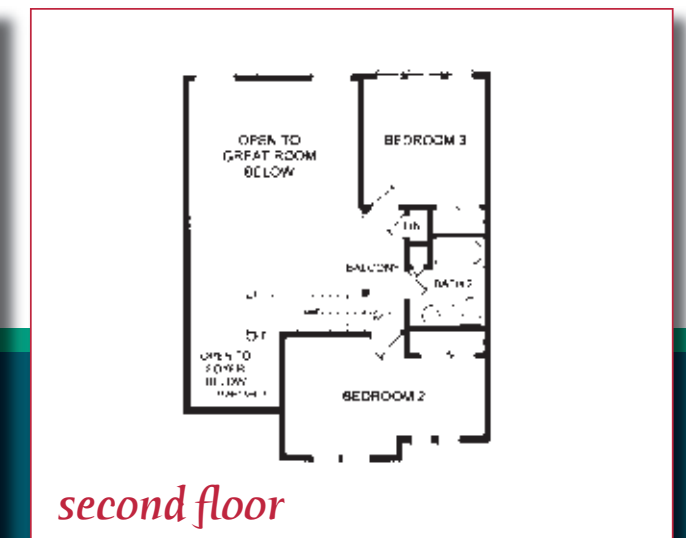

second floor